

auto electrical parts

Technical Information Sheet

Part No. 0-008-50

Heavy Duty Butt Splice Connector

Durite's Heavy Duty Butt Splice Connector. Used to connect or splice two wires to lengthen, change or repair an electrical circuit. Suitable for Automotive, Marine, Commercial and Industrial Applications.

Size: 35mm²

Material: Tin Plated Copper



Technical Drawing (not to scale)

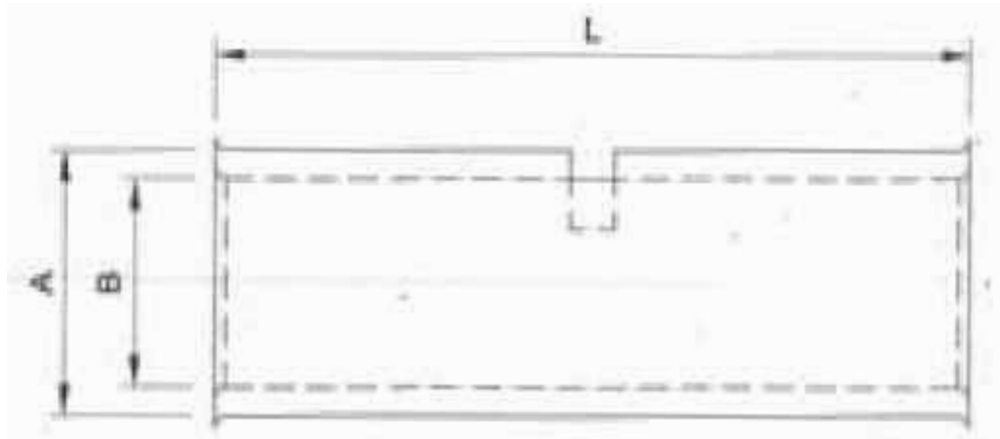

Specification

Size:	35mm ²
Material:	Tin Plated Copper
Colour:	Silver
Certificate:	n/a
Dimensions:	OD: 10.5mm. ID: 8.2mm ² . L: 39mm

The information contained in this document is correct to the best of our knowledge at the time of printing. However, specifications may change at any time without notice.

Gordon Equipments Limited

Durite Works
Valley Road
Dovercourt
Essex CO12 4RX
England



Tel: +44 (0)1255 555200
Fax: +44 (0)1255 555222
E-mail: sales@durite.co.uk
Web: www.durite.co.uk

Registered in England at address shown No. 373113
The words 'Gordon', 'Durite', 'Nolten' and 'Acfil' are registered trade marks